

# 1W HI-POWER LED SPECIFICATION

HPG8-49KxWlx



| Drawn by | Checked by | Approved by |
|----------|------------|-------------|
|          |            |             |
|          |            |             |

RoHS  
Conformity

DATE:2013/3/5

REV:A



**HUEY JANN ELECTRONICS INDUSTRY CO., LTD.**

No.27 Line 466 Sec.2,Canng-nan Rd. Wu-chi Town Taichung Shien, Taiwan, R.O.C.

TEL:+886-4-26393976 FAX:+886-4-26393125

HUEY JANN High Power 1W LED is made of GaInN chips with precise package technique which makes excellent heat dissipation to reach the advantages of high luminous efficiency, low decay, and long endurance. Now we have these colors available: red, green, blue, white, yellow and infrared.

#### FEATERUS

- Instant light
- Long operating life
- Superior ESD defense
- Low voltage DC operated
- More energy efficient than incandescent and most halogen lamps

#### TYPICAL APPLICATIONS

- Architectural detail lighting
- Portable flashlight
- Medical applications
- Beacon lights
- Decoration lights
- Spotlight



**HUEY JANN ELECTRONICS INDUSTRY CO., LTD.**

No.27 Line 466 Sec.2,Canng-nan Rd. Wu-chi Town Taichung Shien, Taiwan, R.O.C.

TEL:+886-4-26393976 FAX:+886-4-26393125

PACKAGE DIMENSIONS:

Emitter Type

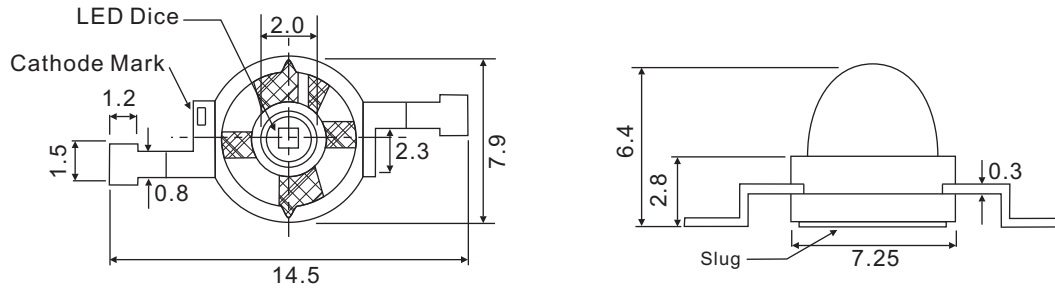

Star Type

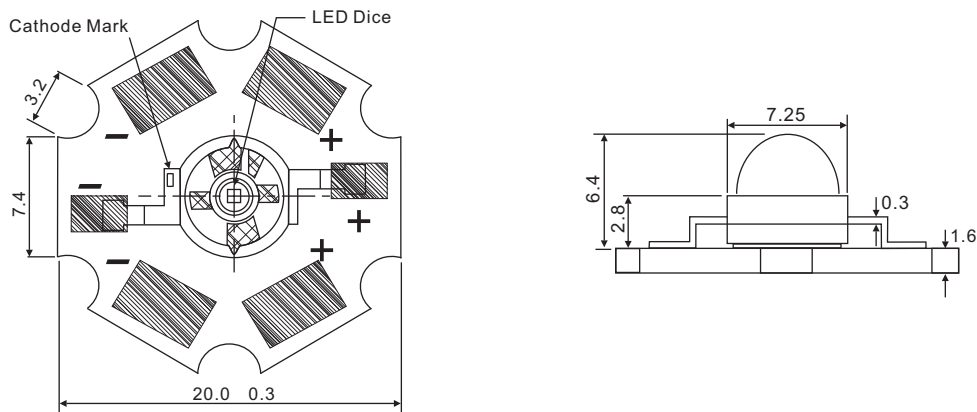

NOTE:

- 1.All dimensions are in millimeter.
- 2.Lead spacing is measured where the lead emerge from the package.
- 3.protruded resin under flange is 1.5mm max.
- 4.specifications are subject to change without notice.
- 5.Tolerance is  $\pm 0.3$ mm unless otherwise noted.
- 6.Driving LED without heat sinking device is forbidden.
- 7.It is strongly recommended that the temperature of lead be not higher than 55°C.
- 8.Proper current derating must be observed to maintain junction temperature below the maximum.
- 9.LEDs are not designed to be driven in reserve bias.



**HUEY JANN ELECTRONICS INDUSTRY CO., LTD.**

No.27 Line 466 Sec.2,Canng-nan Rd. Wu-chi Town Taichung Shien, Taiwan, R.O.C.

TEL:+886-4-26393976 FAX:+886-4-26393125

☰ **DEVICES**

| Item                            | Lens<br>Color | Dice<br>Source | Color<br>Temperature<br>Typ (°K) |
|---------------------------------|---------------|----------------|----------------------------------|
| HPG8-49KWI                      | Water Clear   | GaInN/GaN      | 6000                             |
| HPG8-49KWI/WPCB                 |               |                |                                  |
| HPG8-49KYWI(4000°K)             |               |                | 4000                             |
| HPG8-49KYWI(4000°K)/WPCB        |               |                |                                  |
| HPG8-49KYWI(4000°K)/CRI 90      |               |                |                                  |
| HPG8-49KYWI(4000°K)/CRI 90/WPCB |               |                |                                  |
| HPG8-49KYWI                     |               |                | 3300                             |
| HPG8-49KYWI/WPCB                |               |                |                                  |
| HPG8-49KYWI/CRI 90              |               |                |                                  |
| HPG8-49KYWI/CRI 90/WPCB         |               |                |                                  |



**HUEY JANN ELECTRONICS INDUSTRY CO., LTD.**

No.27 Line 466 Sec.2,Canng-nan Rd. Wu-chi Town Taichung Shien, Taiwan, R.O.C.

TEL:+886-4-26393976 FAX:+886-4-26393125

**ABSOLUTE MAXIMUM RATINGS**

TA=25°C

| PARAMETER   | SYMBOL | MAX. RATING | UNIT |
|---|--------|-------------|------|
| Continuous Forward Current                                | IF     | 350         | mA   |
| Peak Forward Current *1                                   | IFM    | 500         | mA   |
| Electrostatic Discharge(HBM)                              | ESD    | 4000        | V    |
| LED Junction Temperature                                  | Tj     | 135         | °C   |
| Operating Temperature                                     | Topr   | -40 ~ +110  | °C   |
| Storage Temperature                                       | Tstg   | -40 ~ +120  | °C   |
| Manual Soldering Temperature 260 °C for 5 seconds max. *2 |        |             |      |

\*1.Duty Ratio=0.1%,Pulse Width=10us.

\*2.Iron soldering high temperature will not cause damage to the dice. But be aware of the high temperature will not only make the epoxy soften but also cause the lead moving and the gold wire broken and even open. So before returning to the normal temperatures PLEASE AVOID any serious pressure on the top of epoxy and lead.



**HUEY JANN ELECTRONICS INDUSTRY CO., LTD.**

No.27 Line 466 Sec.2,Cannng-nan Rd. Wu-chi Town Taichung Shien, Taiwan, R.O.C.

TEL:+886-4-26393976 FAX:+886-4-26393125

**ELECTRIC-OPTICAL CHARACTERISTICS IN COMMON**

TA=25°C

| Parameter  | Symbol              | Test Condition | Typ | Max | Unit  |
|--|---------------------|----------------|-----|-----|-------|
| View Angle of Half Power                                     | 2θ <sub>1/2</sub>   | IF=350mA       | 45  |     | deg   |
| Forward Voltage  | V <sub>F</sub>      |                | 3.0 | 3.3 | V     |
| Thermal Resistance Junction To Case                          | R <sub>θ J-C</sub>  |                | 15  |     | °C/W  |
| Thermal Resistance Junction To Case With Star Type Heat Sink | R <sub>θ J-C</sub>  |                | 20  |     | °C/W  |
| Temperature Coefficient Of Forward Voltage                   | ΔV <sub>F</sub> /ΔT |                | -2  |     | mV/°C |

**ELECTRIC-OPTICAL CHARACTERISTICS TO BE INDEPENDENT**

IF=350mA TA=25°C

| Item                            | CCT (°K) | CRI (Ra) | Brightness (lm) |
|---------------------------------|----------|----------|-----------------|
|                                 | Typical  |          |                 |
| HPG8-49KWI                      | 6000     | 75       | 113             |
| HPG8-49KWI/WPCB                 |          |          |                 |
| HPG8-49KYWI(4000°K)             | 4000     | 72       | 107             |
| HPG8-49KYWI(4000°K)/WPCB        |          |          |                 |
| HPG8-49KYWI(4000°K)/CRI 90      |          | 90       | 88              |
| HPG8-49KYWI(4000°K)/CRI 90/WPCB |          |          |                 |
| HPG8-49KYWI                     | 3300     | 70       | 101             |
| HPG8-49KYWI/WPCB                |          |          |                 |
| HPG8-49KYWI/CRI 90              |          | 90       | 83              |
| HPG8-49KYWI/CRI 90/WPCB         |          |          |                 |



**HUEY JANN ELECTRONICS INDUSTRY CO., LTD.**

No.27 Line 466 Sec.2,Canng-nan Rd. Wu-chi Town Taichung Shien, Taiwan, R.O.C.

TEL:+886-4-26393976 FAX:+886-4-26393125

## RELIABILITY TEST

### ➤ Endurance Test

| Test Item                                    | Reference Standard                                      | Test Conditions  | Result |
|--|---|--|--------|
| Operation Life                               | MIL-STD-750:1026<br>MIL-STD-883:1005<br>JIS-C-7021 :B-1 | Connect with a power if=350mA<br>Ta=Under room temperature<br>Test Time=1,000hrs | 0/22   |
| High Temperature<br>High Humidity<br>Storage | MIL-STD-202:103B<br>JIS-C-7021 :B-11                    | Ta=+85°C+/-5°C<br>RH=80% ~ 85%<br>Test Time=1,000hrs                             | 0/22   |
| High Temperature<br>Storage                  | MIL-STD-883:1008<br>JIS-C-7021 :B-10                    | High Ta=+120°C+/-5°C<br>Test Time=1,000hrs                                       | 0/22   |
| Low Temperature<br>Storage                   | JIS-C-7021 :B-12  | Low Ta=-40°C+/-5°C<br>Test Time=1,000hrs   | 0/22   |

\*Failure Criteria:

1. VF arise  $\geq 10\%$
2. IV decline  $\geq 30\%$
3. A failure is an LED that is open or shorted



**HUEY JANN ELECTRONICS INDUSTRY CO., LTD.**

No.27 Line 466 Sec.2,Canng-nan Rd. Wu-chi Town Taichung Shien, Taiwan, R.O.C.

TEL:+886-4-26393976 FAX:+886-4-26393125

## RELIABILITY TEST

### ➤ Environmental Test

| Test Item              | Reference Standard  | Test Conditions  | Result |
|------------------------|---|--|--------|
| Temperature<br>Cycling | MIL-STD-202:107D<br>MIL-STD-750:1051<br>MIL-STD-883:1010<br>JIS-C-7021 :A-4 | -40°C ~ +25°C ~ +85°C ~ +25°C<br>60min 20min 60min 20min<br>Test Time=200cycle | 0/22   |
| Thermal<br>Shock       | MIL-STD-202:107D<br>MIL-STD-750:1051<br>MIL-STD-883:1010                    | -40°C+/-5°C ~ +110°C+/-5°C<br>20min 20min<br>Test Time=200cycle                | 0/22   |

\*Failure Criteria:

1. VF arise  $\geq 10\%$
2. IV decline  $\geq 30\%$
3. A failure is an LED that is open or shorted



**HUEY JANN ELECTRONICS INDUSTRY CO., LTD.**

No.27 Line 466 Sec.2,Canng-nan Rd. Wu-chi Town Taichung Shien, Taiwan, R.O.C.

TEL:+886-4-26393976 FAX:+886-4-26393125



TYPICAL ELECTRICAL OPTICAL CHARACTERISTICS CURVES

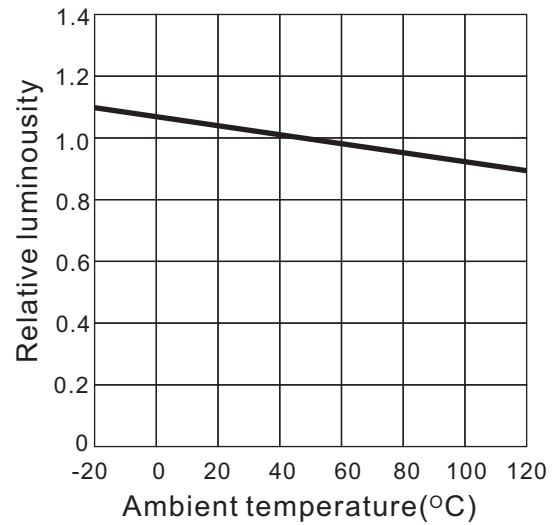
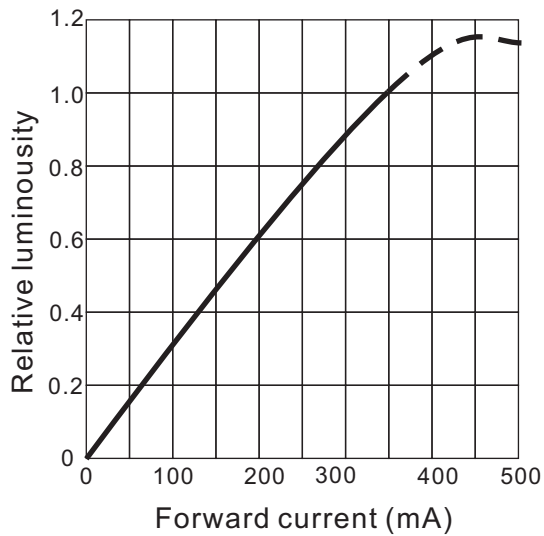
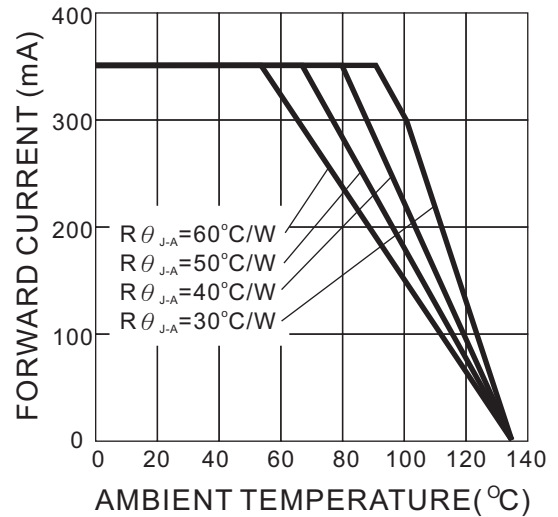
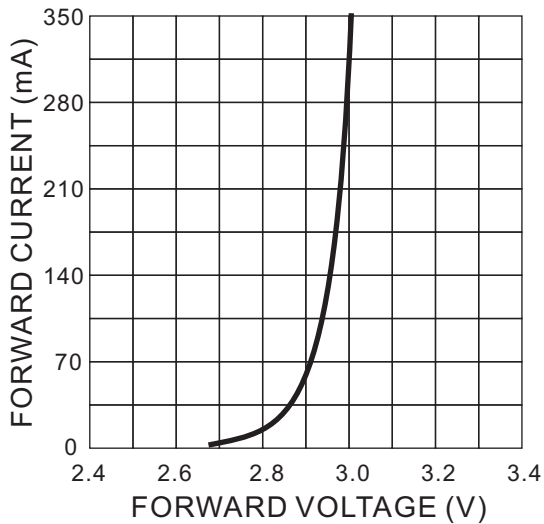

HUEY JANN ELECTRONICS INDUSTRY CO., LTD.

No.27 Line 466 Sec.2,Canng-nan Rd. Wu-chi Town Taichung Shien, Taiwan, R.O.C.

TEL:+886-4-26393976 FAX:+886-4-26393125

## TYPICAL ELECTRICAL OPTICAL CHARACTERISTICS CURVES

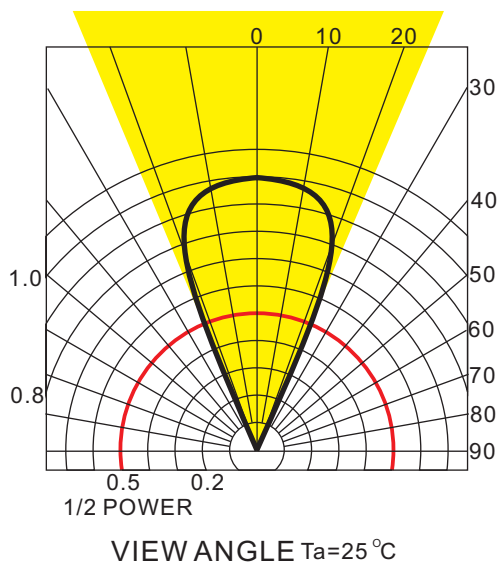
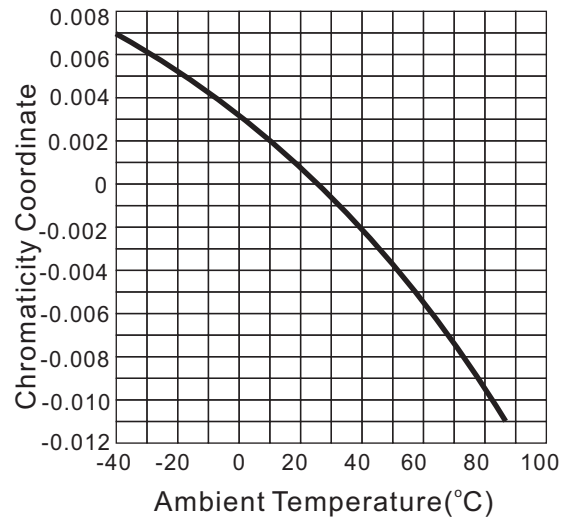
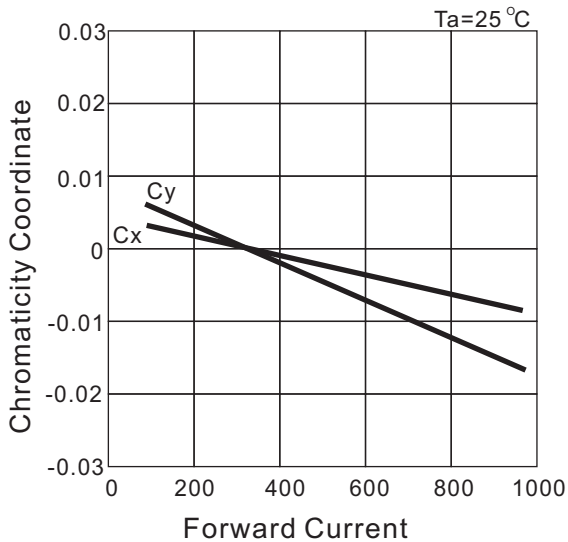

**HUEY JANN ELECTRONICS INDUSTRY CO., LTD.**

No.27 Line 466 Sec.2,Canng-nan Rd. Wu-chi Town Taichung Shien, Taiwan, R.O.C.

TEL:+886-4-26393976 FAX:+886-4-26393125

TYPICAL ELECTRICAL OPTICAL CHARACTERISTICS CURVES

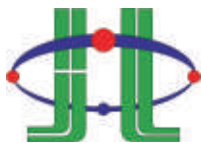
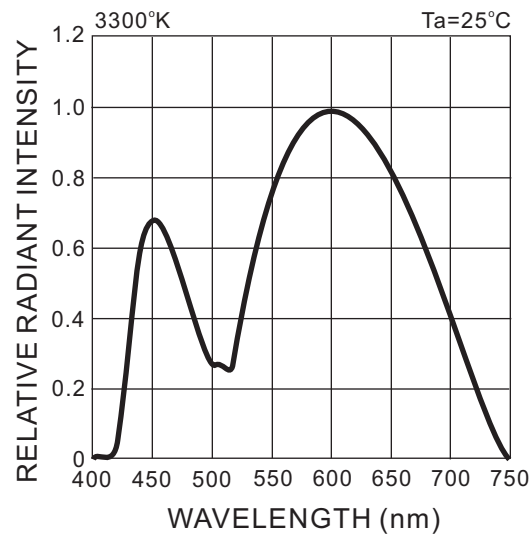
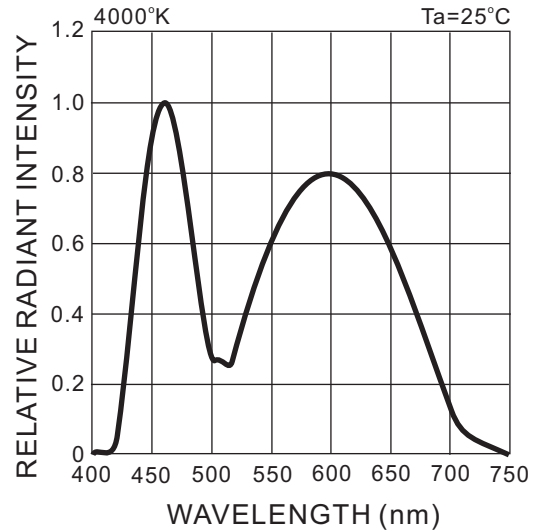
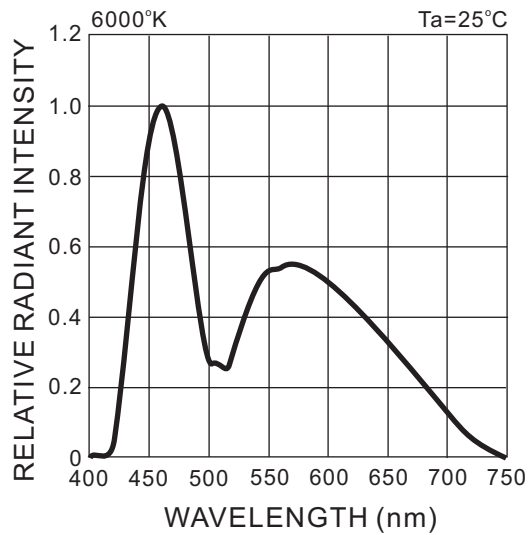

**HUEY JANN ELECTRONICS INDUSTRY CO., LTD.**

No.27 Line 466 Sec.2,Canng-nan Rd. Wu-chi Town Taichung Shien, Taiwan, R.O.C.

TEL:+886-4-26393976 FAX:+886-4-26393125

Brightness Bin Selection

| Item                        | BIN CODE | Brightness in lm |         |
|-----------------------------|----------|------------------|---------|
|                             |          | Minimum          | Maximum |
| HPG8-49KWlx                 | L        | 85               | 110     |
|                             | M        | 110              | 143     |
| HPG8-49KYWI(4000°K)x        | L        | 85               | 110     |
|                             | M        | 110              | 143     |
| HPG8-49KYWI(4000°K)/CRI 90x | K        | 65               | 85      |
|                             | L        | 85               | 110     |
| HPG8-49KYWlx                | L        | 85               | 110     |
|                             | M        | 110              | 143     |
| HPG8-49KYWI/CRI 90x         | K        | 65               | 85      |
|                             | L        | 85               | 110     |

NOTE:

1. Test Condition at IF=350mA.



**HUEY JANN ELECTRONICS INDUSTRY CO., LTD.**

No.27 Line 466 Sec.2,Canng-nan Rd. Wu-chi Town Taichung Shien, Taiwan, R.O.C.

TEL:+886-4-26393976 FAX:+886-4-26393125

Pure White Color Bin Selection

| Bin | CCT(°K) | Chromaticity Coordinates |       |       |       |       |
|-----|---------|--------------------------|-------|-------|-------|-------|
|     | TYP     |                          |       |       |       |       |
| T1  | 9000    | x                        | 0.274 | 0.292 | 0.299 | 0.283 |
|     |         | y                        | 0.301 | 0.322 | 0.300 | 0.284 |
| T2  | 9000    | x                        | 0.283 | 0.299 | 0.303 | 0.290 |
|     |         | y                        | 0.284 | 0.300 | 0.283 | 0.270 |
| T3  | 8000    | x                        | 0.292 | 0.303 | 0.308 | 0.299 |
|     |         | y                        | 0.322 | 0.333 | 0.311 | 0.300 |
| T4  | 8000    | x                        | 0.299 | 0.308 | 0.311 | 0.303 |
|     |         | y                        | 0.300 | 0.311 | 0.293 | 0.283 |
| T5  | 6700    | x                        | 0.301 | 0.314 | 0.316 | 0.305 |
|     |         | y                        | 0.342 | 0.355 | 0.333 | 0.322 |
| T6  | 6700    | x                        | 0.305 | 0.316 | 0.317 | 0.308 |
|     |         | y                        | 0.322 | 0.333 | 0.320 | 0.311 |
| T7  | 6700    | x                        | 0.308 | 0.317 | 0.319 | 0.311 |
|     |         | y                        | 0.311 | 0.320 | 0.300 | 0.293 |
| T8  | 6000    | x                        | 0.314 | 0.329 | 0.329 | 0.316 |
|     |         | y                        | 0.355 | 0.369 | 0.345 | 0.333 |
| T9  | 6000    | x                        | 0.316 | 0.329 | 0.329 | 0.317 |
|     |         | y                        | 0.333 | 0.345 | 0.331 | 0.320 |
| T10 | 6000    | x                        | 0.317 | 0.329 | 0.329 | 0.319 |
|     |         | y                        | 0.320 | 0.331 | 0.310 | 0.300 |
| T11 | 5300    | x                        | 0.329 | 0.348 | 0.346 | 0.329 |
|     |         | y                        | 0.369 | 0.385 | 0.359 | 0.345 |
| T12 | 5300    | x                        | 0.329 | 0.346 | 0.329 | 0.344 |
|     |         | y                        | 0.345 | 0.359 | 0.331 | 0.344 |
| T13 | 5300    | x                        | 0.344 | 0.329 | 0.343 | 0.329 |
|     |         | y                        | 0.344 | 0.331 | 0.331 | 0.320 |
| T14 | 4750    | x                        | 0.348 | 0.367 | 0.362 | 0.346 |
|     |         | y                        | 0.385 | 0.400 | 0.372 | 0.359 |
| T15 | 4750    | x                        | 0.346 | 0.362 | 0.360 | 0.344 |
|     |         | y                        | 0.359 | 0.372 | 0.357 | 0.344 |



**HUEY JANN ELECTRONICS INDUSTRY CO., LTD.**

No.27 Line 466 Sec.2,Canng-nan Rd. Wu-chi Town Taichung Shien, Taiwan, R.O.C.

TEL:+886-4-26393976 FAX:+886-4-26393125

## Pure White Color Bin Selection

### CIE Light Color Chart

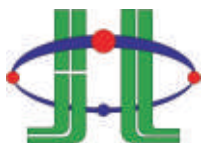
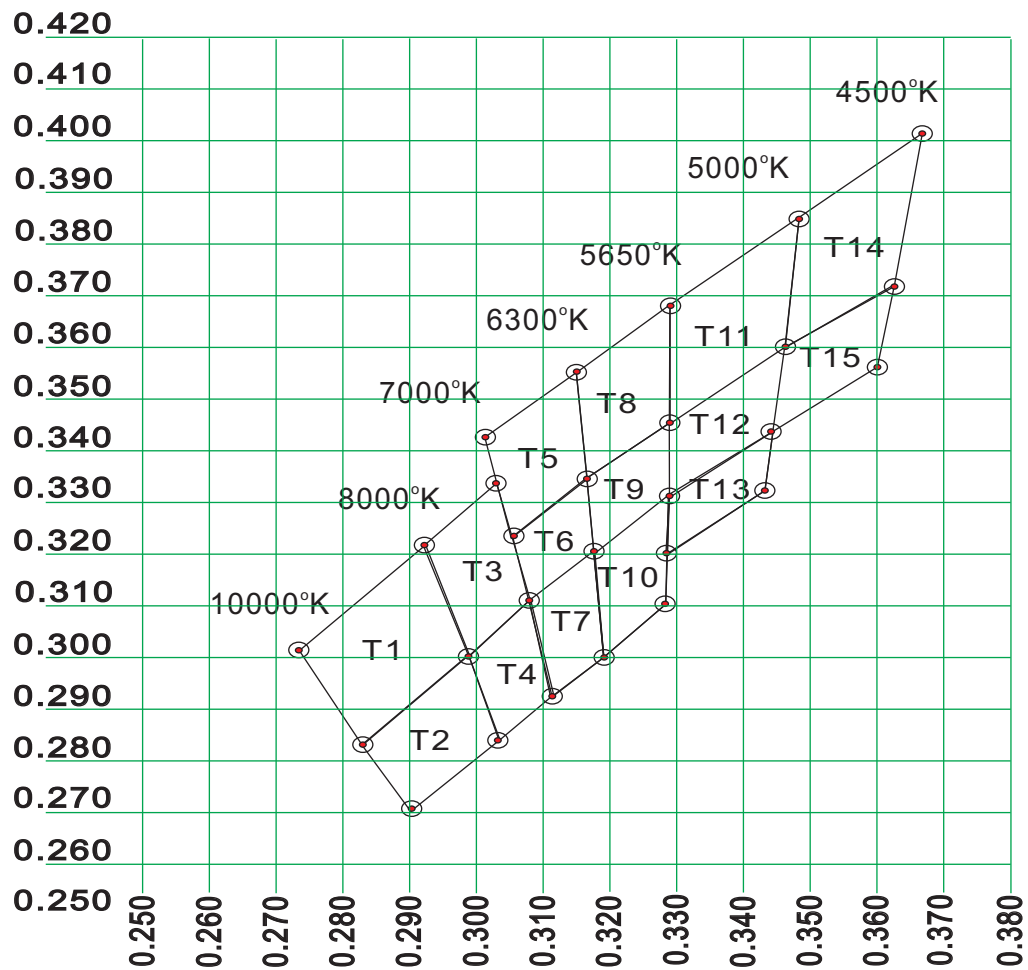

**HUEY JANN ELECTRONICS INDUSTRY CO., LTD.**

No.27 Line 466 Sec.2,Canng-nan Rd. Wu-chi Town Taichung Shien, Taiwan, R.O.C.

TEL:+886-4-26393976 FAX:+886-4-26393125

☐ Nature White Color Bin Selection

| Bin | CCT(°K) | Chromaticity Coordinates |       |       |       |       |
|-----|---------|--------------------------|-------|-------|-------|-------|
|     | TYP     |                          |       |       |       |       |
| N1  | 4300    | x                        | 0.367 | 0.385 | 0.381 | 0.364 |
|     |         | y                        | 0.400 | 0.412 | 0.393 | 0.382 |
| N2  | 4300    | x                        | 0.364 | 0.381 | 0.378 | 0.362 |
|     |         | y                        | 0.382 | 0.393 | 0.382 | 0.371 |
| N3  | 4300    | x                        | 0.362 | 0.378 | 0.374 | 0.359 |
|     |         | y                        | 0.371 | 0.382 | 0.365 | 0.355 |
| N4  | 4300    | x                        | 0.359 | 0.374 | 0.370 | 0.357 |
|     |         | y                        | 0.355 | 0.365 | 0.351 | 0.342 |
| N5  | 3950    | x                        | 0.385 | 0.402 | 0.396 | 0.381 |
|     |         | y                        | 0.412 | 0.422 | 0.403 | 0.393 |
| N6  | 3950    | x                        | 0.381 | 0.396 | 0.392 | 0.378 |
|     |         | y                        | 0.393 | 0.403 | 0.390 | 0.382 |
| N7  | 3950    | x                        | 0.378 | 0.392 | 0.387 | 0.374 |
|     |         | y                        | 0.382 | 0.390 | 0.373 | 0.365 |
| N8  | 3950    | x                        | 0.370 | 0.387 | 0.382 | 0.357 |
|     |         | y                        | 0.351 | 0.373 | 0.359 | 0.342 |
| N9  | 3650    | x                        | 0.402 | 0.420 | 0.414 | 0.396 |
|     |         | y                        | 0.422 | 0.432 | 0.416 | 0.403 |
| N10 | 3650    | x                        | 0.396 | 0.414 | 0.408 | 0.392 |
|     |         | y                        | 0.403 | 0.416 | 0.399 | 0.390 |
| N11 | 3650    | x                        | 0.392 | 0.408 | 0.402 | 0.387 |
|     |         | y                        | 0.390 | 0.399 | 0.382 | 0.373 |
| N12 | 3650    | x                        | 0.387 | 0.402 | 0.396 | 0.382 |
|     |         | y                        | 0.373 | 0.382 | 0.367 | 0.359 |



**HUEY JANN ELECTRONICS INDUSTRY CO., LTD.**

No.27 Line 466 Sec.2,Canng-nan Rd. Wu-chi Town Taichung Shien, Taiwan, R.O.C.

TEL:+886-4-26393976 FAX:+886-4-26393125

## Nature White Color Bin Selection

### ➤ CIE Light Color Chart

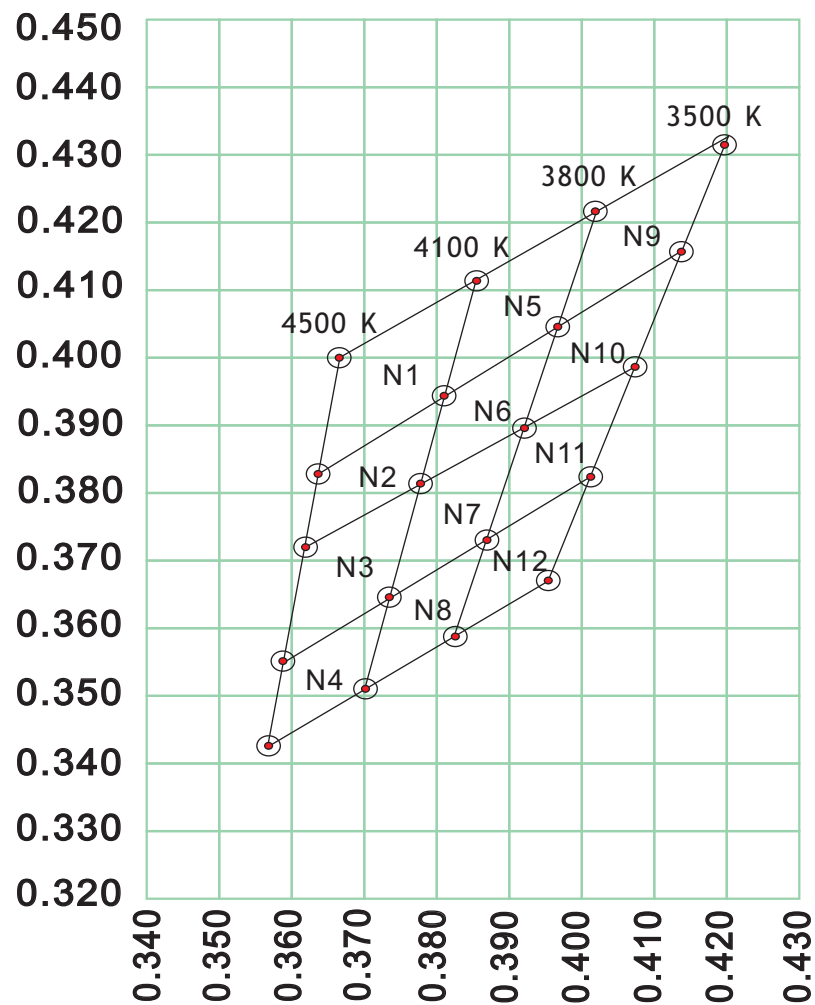

**HUEY JANN ELECTRONICS INDUSTRY CO., LTD.**

No.27 Line 466 Sec.2,Canng-nan Rd. Wu-chi Town Taichung Shien, Taiwan, R.O.C.

TEL:+886-4-26393976 FAX:+886-4-26393125



Warm White Color Bin Selection

| Bin | CCT(°K) | Chromaticity Coordinates |       |       |       |       |
|-----|---------|--------------------------|-------|-------|-------|-------|
|     | TYP     |                          |       |       |       |       |
| C10 | 3640    | x                        | 0.402 | 0.417 | 0.409 | 0.392 |
|     |         | y                        | 0.423 | 0.431 | 0.400 | 0.391 |
| C11 | 3500    | x                        | 0.402 | 0.438 | 0.424 | 0.392 |
|     |         | y                        | 0.423 | 0.440 | 0.406 | 0.391 |
| C12 | 3640    | x                        | 0.392 | 0.409 | 0.402 | 0.387 |
|     |         | y                        | 0.391 | 0.400 | 0.382 | 0.374 |
| C13 | 3370    | x                        | 0.409 | 0.424 | 0.416 | 0.402 |
|     |         | y                        | 0.400 | 0.406 | 0.389 | 0.382 |
| C14 | 3500    | x                        | 0.387 | 0.416 | 0.410 | 0.383 |
|     |         | y                        | 0.374 | 0.389 | 0.374 | 0.360 |
| C15 | 3150    | x                        | 0.438 | 0.454 | 0.438 | 0.424 |
|     |         | y                        | 0.440 | 0.446 | 0.412 | 0.406 |
| C16 | 3150    | x                        | 0.424 | 0.438 | 0.429 | 0.416 |
|     |         | y                        | 0.406 | 0.412 | 0.394 | 0.389 |
| C17 | 2950    | x                        | 0.454 | 0.471 | 0.453 | 0.438 |
|     |         | y                        | 0.446 | 0.451 | 0.416 | 0.412 |
| C18 | 2950    | x                        | 0.438 | 0.453 | 0.444 | 0.429 |
|     |         | y                        | 0.412 | 0.416 | 0.399 | 0.394 |



**HUEY JANN ELECTRONICS INDUSTRY CO., LTD.**

No.27 Line 466 Sec.2,Canng-nan Rd. Wu-chi Town Taichung Shien, Taiwan, R.O.C.

TEL:+886-4-26393976 FAX:+886-4-26393125

## Warm White Color Bin Selection

### ➤ CIE Light Color Chart

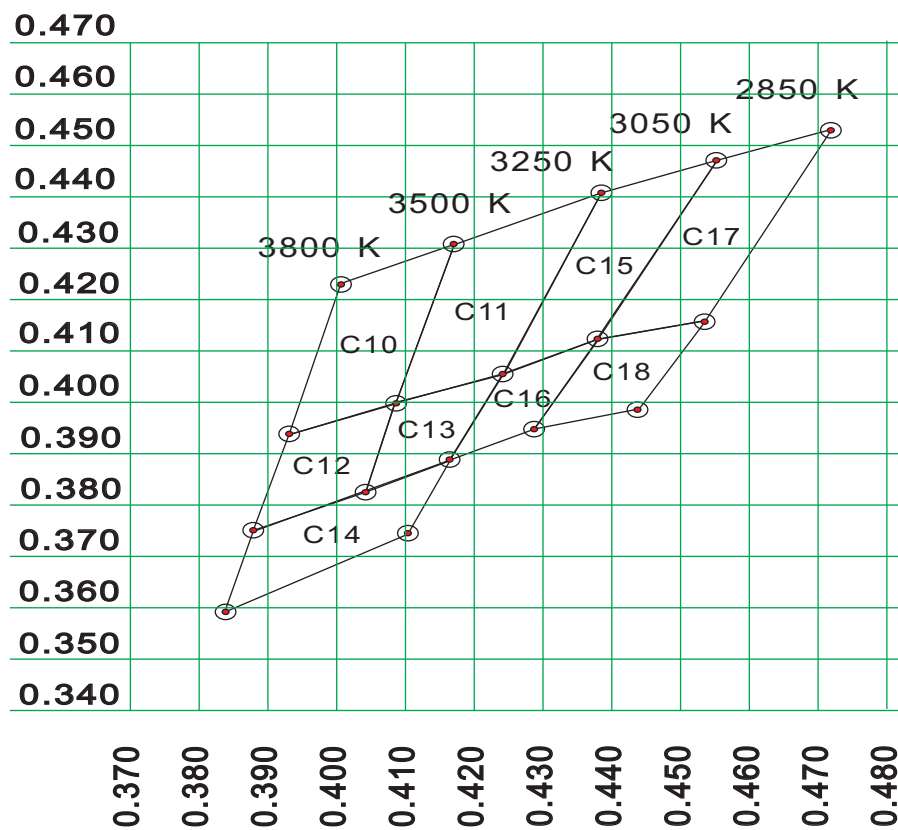

**HUEY JANN ELECTRONICS INDUSTRY CO., LTD.**

No.27 Line 466 Sec.2, Canng-nan Rd. Wu-chi Town Taichung Shien, Taiwan, R.O.C.

TEL:+886-4-26393976 FAX:+886-4-26393125

Package Dimension For Emitter Type

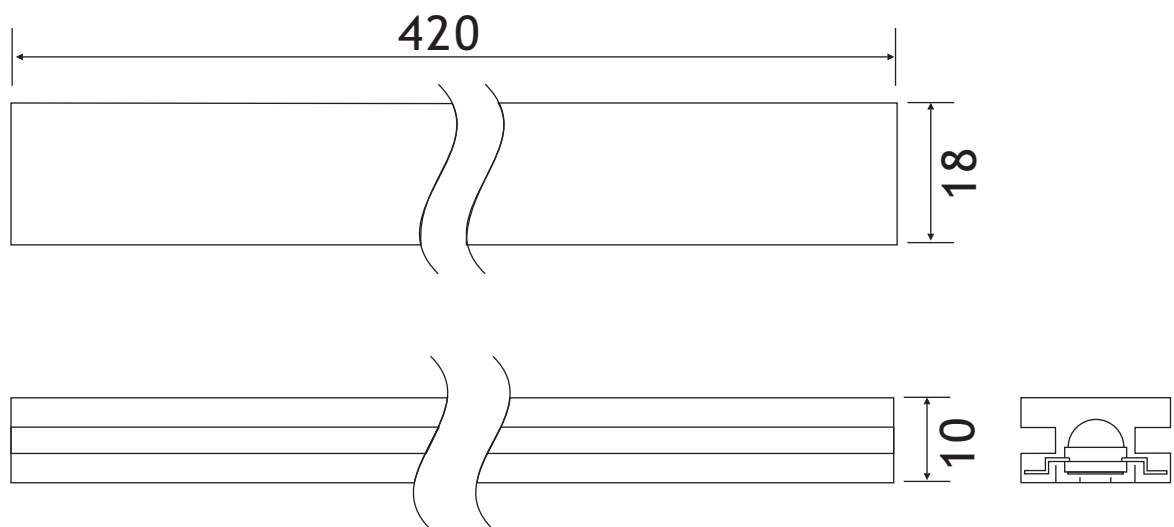

NOTE:

1. Dimensions are specified as follows: mm.
2. Tolerance is  $\pm 0.3$ mm unless otherwise noted.
3. 50 pcs emitters per tube.
4. 80 tubes per inside box.
5. 4 inside box per outside box.



**HUEY JANN ELECTRONICS INDUSTRY CO., LTD.**

No.27 Line 466 Sec.2,Canng-nan Rd. Wu-chi Town Taichung Shien, Taiwan, R.O.C.

TEL:+886-4-26393976 FAX:+886-4-26393125

Package Dimension For Star Type

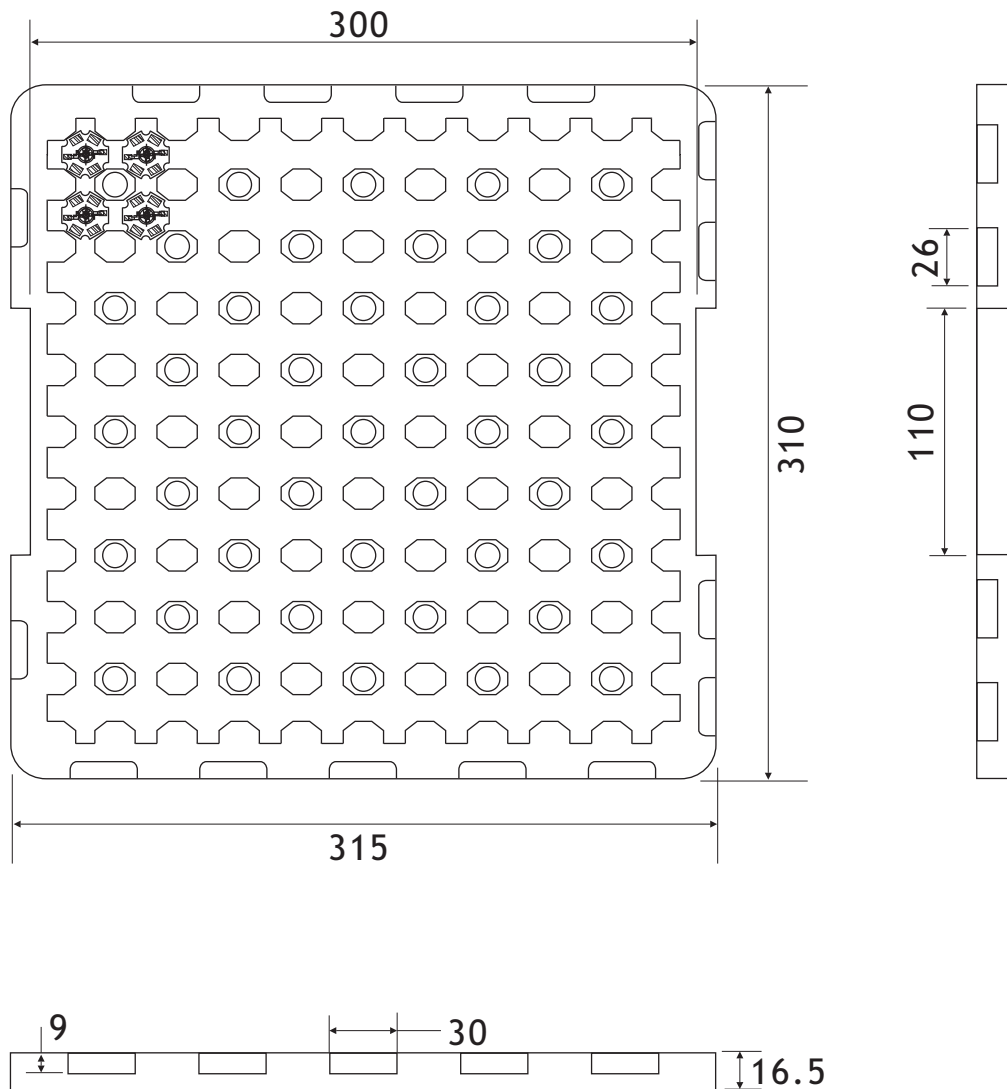

NOTE:

1. Dimensions are specified as follows: mm.
2. Tolerance is  $\pm 0.3$ mm unless otherwise noted.
3. 100pcs star per tray.
4. 10 trays per box.



**HUEY JANN ELECTRONICS INDUSTRY CO., LTD.**

No.27 Line 466 Sec.2,Canng-nan Rd. Wu-chi Town Taichung Shien, Taiwan, R.O.C.

TEL:+886-4-26393976 FAX:+886-4-26393125

☐ **Requirements to user For Emitter Type**

The LED products by HUEY-JANN is designed, manufactured, and sold aiming at high standard quality and reliability, however, reliability of electronic apparatus is seen as a product of reliability superior to HUEY-JANN and using status at users. From this point, HUEY-JANN requests user's for following things.

☐ **Recommended Solder Pad Design For Emitter Type**

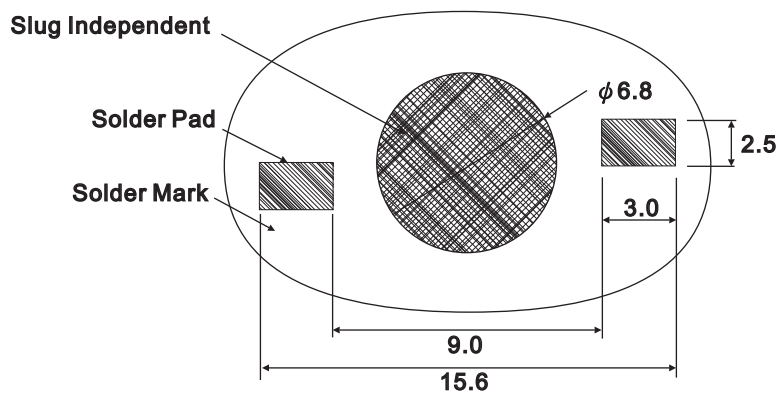

Note:

- 1.All dimensions are in millimeters.
- 2.Electrical isolation is required between Slug and Solder Pad.



**HUEY JANN ELECTRONICS INDUSTRY CO., LTD.**

No.27 Line 466 Sec.2,Canng-nan Rd. Wu-chi Town Taichung Shien, Taiwan, R.O.C.

TEL:+886-4-26393976 FAX:+886-4-26393125

## Heat Plate Soldering Condition For Emitter Type

### a. Soldering Process for Solder Paste

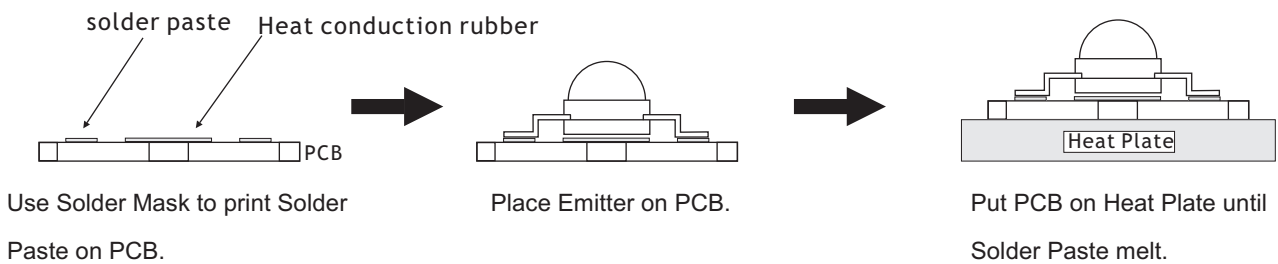

**NOTE:**

- 1.The Solder Paste should be melted within 10 seconds.
- 2.Take out PCB out from Heat Plate within 15 seconds.
- 3.LED need to be closely integrated with the thermal structure

### b. Soldering Process for Solder Wire

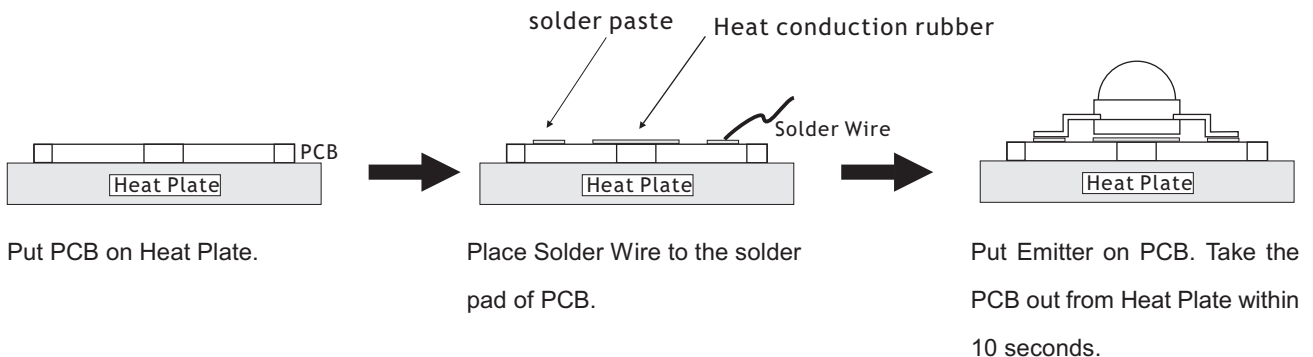

**NOTE:**

- 1.Heat plate temperature: 230°C max for Lead Solder and 260 °C max for Lead-Free Solder.
- 2.When soldering, do not put stress on the LEDs during heating.
- 3.After soldering, do not warp the circuit board.
- 4.LED need to be closely integrated with the thermal structure



**HUEY JANN ELECTRONICS INDUSTRY CO., LTD.**

No.27 Line 466 Sec.2,Cannng-nan Rd. Wu-chi Town Taichung Shien, Taiwan, R.O.C.

TEL:+886-4-26393976 FAX:+886-4-26393125

## Soldering Process For Hot Bar For Emitter Type

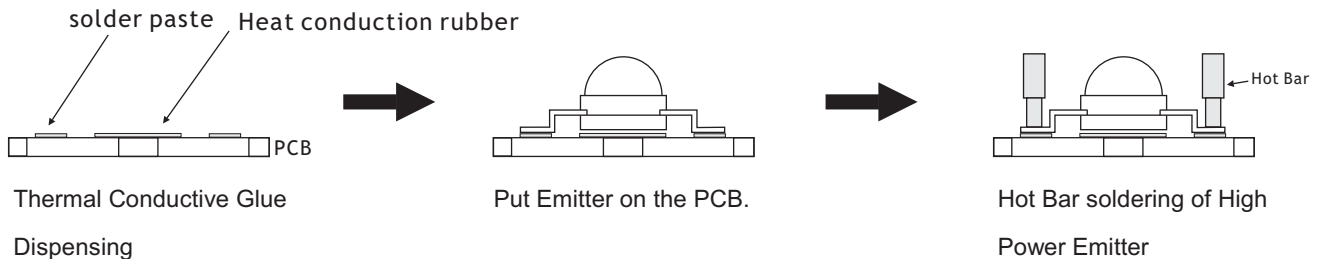

### NOTE:

1. Hot Bar temperature: 230°C max for Lead Solder and 260°C max for Lead-Free Solder.
2. When soldering, do not put stress on the LEDs during heating.
3. After soldering, do not warp the circuit board.
4. LED need to be closely integrated with the thermal structure

## Manual Hand Soldering For Emitter Type

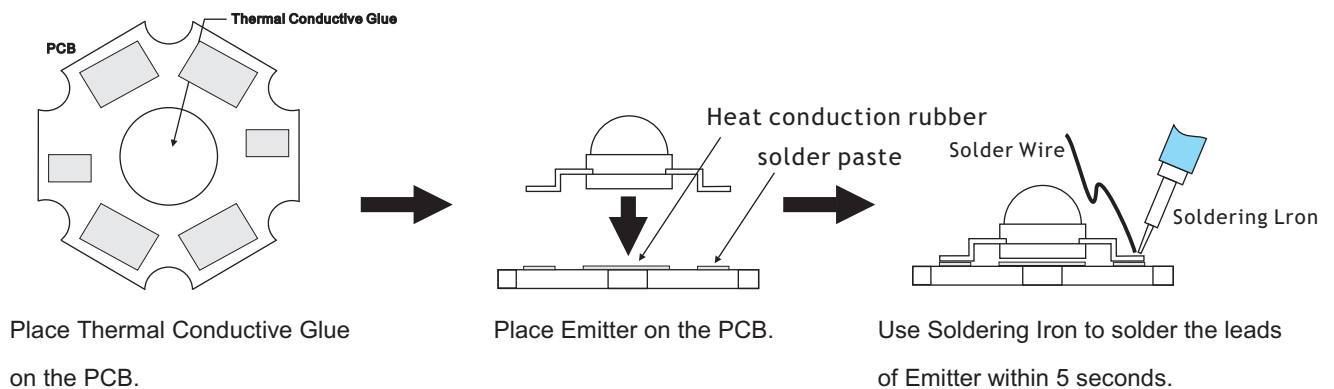

### NOTE:

1. Solder tip temperature: 230°C max for Lead Solder and 260°C max for Lead-Free Solder.
2. Avoiding damage to the emitter or to the PCB dielectric layer. Damage to the epoxy layer can cause
3. Do not let the solder contact from solder pad to back-side of PCB. This one will cause a short circuit and damage emitter.
4. LED need to be closely integrated with the thermal structure



**HUEY JANN ELECTRONICS INDUSTRY CO., LTD.**

No.27 Line 466 Sec.2, Canng-nan Rd. Wu-chi Town Taichung Shien, Taiwan, R.O.C.

TEL:+886-4-26393976 FAX:+886-4-26393125

## Conclusion

Huey Jann provide simple comparison table for High Power LED, you could find your request heat dissipation area from the following table.

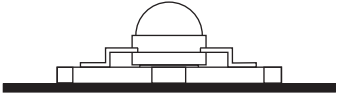
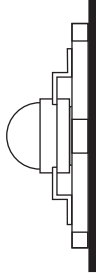
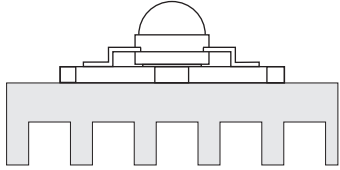
|    |   |   |  |
|----|---|---|--|
|    |  <p>Free Convection Horizontal<br/>Flat Heat Dissipation-Set-up<br/>( Area Require mm<sup>2</sup>)</p> |  <p>Free Convection<br/>Vertical Flat Heat Dissipation-Set-up<br/>( Area Require mm<sup>2</sup>)</p> |  <p>Free Convection<br/>Finned Heat Dissipation-Set-up<br/>( Area Require mm<sup>2</sup>)</p> |
| 1W | 1,800   | 1,500   | 2,400  |

\*TAB in this table is according to highest operating temperature 65°C.

\*Different materials of second heat dissipation device, the surface area of heat sink will be different. Thus, this document is for reference only.



**HUEY JANN ELECTRONICS INDUSTRY CO., LTD.**

No.27 Line 466 Sec.2,Canng-nan Rd. Wu-chi Town Taichung Shien, Taiwan, R.O.C.

TEL:+886-4-26393976 FAX:+886-4-26393125



## TAB Temperature - Life Characteristics Curves

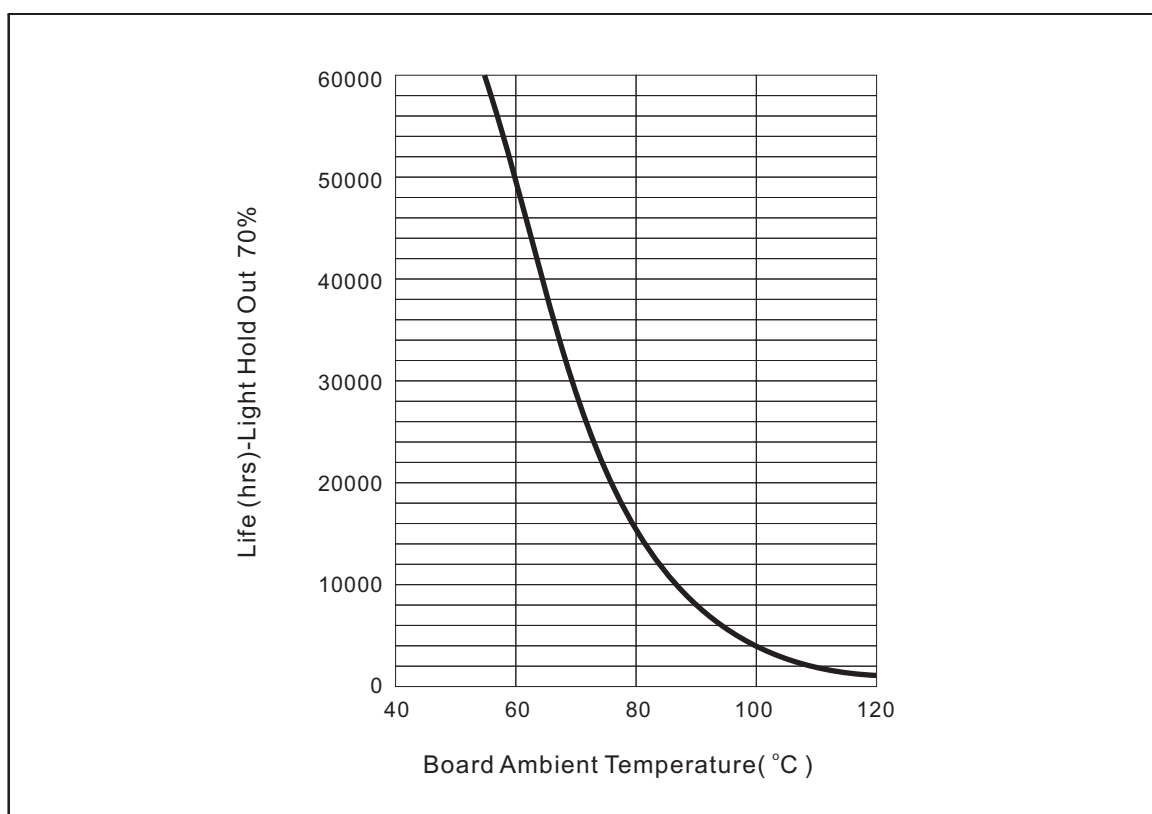
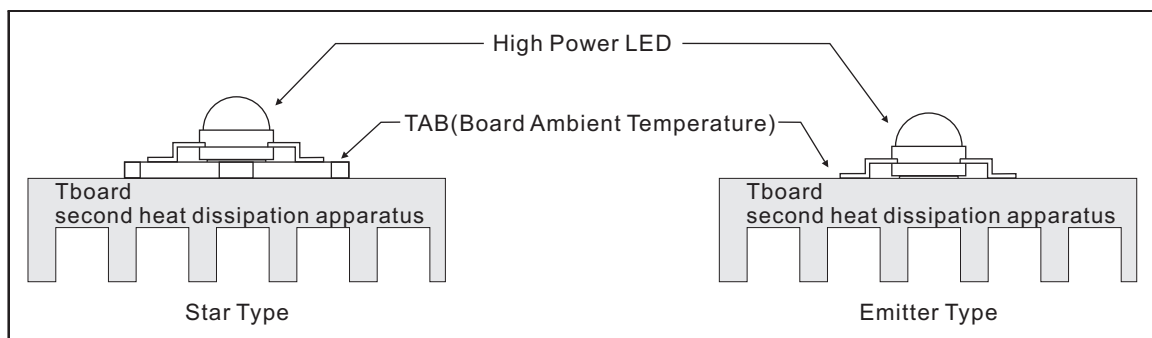

\*Board Ambient Temperature Tolerance  $\pm 5^{\circ}\text{C}$ .

\*TAB in this table is according to highest operating temperature  $65^{\circ}\text{C}$ .

\*The TAB is the stable testing value for the product lighted 100% after one hour.

\*Different materials of second heat dissipation device, the surface area of heat sink will be different. Thus, this document is for reference only.



**HUEY JANN ELECTRONICS INDUSTRY CO., LTD.**

No.27 Line 466 Sec.2,Canng-nan Rd. Wu-chi Town Taichung Shien, Taiwan, R.O.C.

TEL:+886-4-26393976 FAX:+886-4-26393125

**Remarks:**

1. Brightness values are measured during a current pulse of typical 25 ms, the brightness tolerance is  $\pm 15\%$ .
2. Chromaticity coordinates are measured during a current pulse of typical 200 ms, the chromaticity tolerance is  $\pm 0.015$ .
3. Forward voltage are measured during a current pulse of typical 5 ms, the VF tolerance is  $\pm 0.15V$ .
4. Dimensions are specified as follows: mm.
5. Related technical parameters of LED are average value resulted from statistic. The actual parameters of LED could be slightly different from average and characteristic curve.
6. The average value of LED will be changed by technical improvement and elevation, and subject to change without prior notice.
7. Hi-Power LED can not be operated without second heat dissipating structure.
8. Poor or damaged second heat dissipating structure could lead to defective electrical characteristic of High Power LED, CCT(Wavelength) escalation, brightness drop, lifetime shortening or burn out. Following instructions of Huey Jann Hi-Power LED series document can avoid LED burn out and electrical defectiveness due to improper usage, and maintain normal performance of the products.



**HUEY JANN ELECTRONICS INDUSTRY CO., LTD.**

No.27 Line 466 Sec.2,Canng-nan Rd. Wu-chi Town Taichung Shien, Taiwan, R.O.C.

TEL:+886-4-26393976 FAX:+886-4-26393125